

SQUARE FOOTAGE	
LIVING AREA:	4068
LANAI:	392
GARAGE:	868
ENTRY:	90
TOTAL:	5418

GENERAL NOTES

- ALL EXTERIOR FRAME WALLS AND INTERIOR BEARING WALLS TO BE 2X4 WOOD STUDS AT 16" O.C.
- FRAMING BETWEEN THE GARAGE AND RESIDENCE SHALL BE 2X4 WOOD STUDS AT 16" O.C. WITH A MINIMUM OF ONE HONEYCOMB CORE STEEL DOOR NOT LESS THAN 1.38" THICK OR A 20 MINUTE FIRE RATED DOOR.
- ALL EXTERIOR WALKWAY AND FRAME WALLS OVER 32" LONG MUST BE COMPLETE, INSPECTED AND APPROVED BEFORE REQUESTING THE FRAMING INSPECTION. FRG-R109.3
- ALL PLUMBING, ELECTRICAL, AND MECHANICAL ROUGHINS MUST BE COMPLETE, INSPECTED AND APPROVED BEFORE FIRST FLOOR FOR HANDICAP ACCESS. FHC-R R22
- PROVIDE A MINIMUM OF ONE 36" SIDE HINGED EXIT DOOR ON THE FIRST FLOOR.
- ALL INTERIOR WALK-IN CLOSET CEILING TO BE A MAXIMUM OF 8' HIGH.
- ALL INTERIOR WALL WIDTHS ARE SET AT 4" UNLESS OTHERWISE NOTED.
- ALL INTERIOR WALK-IN CLOSET CEILING TO BE A MAXIMUM OF 8' HIGH.
- ALL INTERIOR WALK-IN CLOSET CEILING TO BE A MAXIMUM OF 8' HIGH.
- ALL INTERIOR WALK-IN CLOSET CEILING TO BE A MAXIMUM OF 8' HIGH.
- ALL EXTERIOR CEILING (I.E. PORCHES, ENTRY) GET 1/2" SAG AND VAPOR BARRIER.
- RESISTANT EXTERIOR GYPSUM SHEATHING.
- ALL EXTERIOR DOORS SHALL BE 1 3/4" MINIMUM DOOR THICKNESS WITH 20 MINUTE FIRE RATED DOORS TO GRASSED AREAS.
- ALL SHELVING TO BE VINYL COATED WIRE SHELVING.

REFER TO SHEET SPECIFIC GENERAL NOTES AND THE ENGINEER'S NOTES FOR MORE INFORMATION. THE PREVIOUS GENERAL NOTES APPLY UNLESS OTHERWISE NOTED.

WIND LOAD TABLE
 WIND SPEED: 130 MPH
 WIND IMPORTANCE FACTOR: 1.0
 WIND EXPOSURE: B
 INT. PRESSURE COEFFICIENT (PARTIALLY ENCLOSED): +/- 0.55
 COMPONENTS AND CLADDING

ROOF	10 SFT:	17.64/4.7
	20 SFT:	16.0/5.3
	50 SFT:	13.9/4.6
	100 SFT:	12.4/4.0
WALLS	10 SFT:	30.4/4.0
	20 SFT:	27.3/3.4
	50 SFT:	22.9/3.1
	100 SFT:	20.9/2.8

ALL DOORS AND WINDOWS SHALL BE A MINIMUM DESIGN PRESSURE OF: 30.4/4.0
 ALL GARAGE DOORS SHALL HAVE A MINIMUM DESIGN PRESSURE OF: 28.4/3.6

WINDOW AND DOOR SCHEDULE

ORDING MARK	CALL OUT	MANUFACTURER'S MODEL # OR SERIES NAME	FINISH	GLASS	OPERATION
W1	12'-0" x 16'-0"	ALUMINUM CASING	ANODIZED	CLERESTORY	FIXED
W2	6'-0" x 6'-0"	ALUMINUM CASING	ANODIZED	CLERESTORY	FIXED
W3	6'-0" x 6'-0"	ALUMINUM CASING	ANODIZED	CLERESTORY	FIXED
W4	6'-0" x 6'-0"	ALUMINUM CASING	ANODIZED	CLERESTORY	FIXED
W5	6'-0" x 6'-0"	ALUMINUM CASING	ANODIZED	CLERESTORY	FIXED
W6	6'-0" x 6'-0"	ALUMINUM CASING	ANODIZED	CLERESTORY	FIXED
W7	6'-0" x 6'-0"	ALUMINUM CASING	ANODIZED	CLERESTORY	FIXED
W8	6'-0" x 6'-0"	ALUMINUM CASING	ANODIZED	CLERESTORY	FIXED
W9	6'-0" x 6'-0"	ALUMINUM CASING	ANODIZED	CLERESTORY	FIXED
W10	6'-0" x 6'-0"	ALUMINUM CASING	ANODIZED	CLERESTORY	FIXED
W11	6'-0" x 6'-0"	ALUMINUM CASING	ANODIZED	CLERESTORY	FIXED
W12	6'-0" x 6'-0"	ALUMINUM CASING	ANODIZED	CLERESTORY	FIXED
W13	6'-0" x 6'-0"	ALUMINUM CASING	ANODIZED	CLERESTORY	FIXED
W14	6'-0" x 6'-0"	ALUMINUM CASING	ANODIZED	CLERESTORY	FIXED
W15	6'-0" x 6'-0"	ALUMINUM CASING	ANODIZED	CLERESTORY	FIXED
W16	6'-0" x 6'-0"	ALUMINUM CASING	ANODIZED	CLERESTORY	FIXED
W17	6'-0" x 6'-0"	ALUMINUM CASING	ANODIZED	CLERESTORY	FIXED
W18	6'-0" x 6'-0"	ALUMINUM CASING	ANODIZED	CLERESTORY	FIXED
W19	6'-0" x 6'-0"	ALUMINUM CASING	ANODIZED	CLERESTORY	FIXED
W20	6'-0" x 6'-0"	ALUMINUM CASING	ANODIZED	CLERESTORY	FIXED
W21	6'-0" x 6'-0"	ALUMINUM CASING	ANODIZED	CLERESTORY	FIXED
W22	6'-0" x 6'-0"	ALUMINUM CASING	ANODIZED	CLERESTORY	FIXED
W23	6'-0" x 6'-0"	ALUMINUM CASING	ANODIZED	CLERESTORY	FIXED
W24	6'-0" x 6'-0"	ALUMINUM CASING	ANODIZED	CLERESTORY	FIXED
W25	6'-0" x 6'-0"	ALUMINUM CASING	ANODIZED	CLERESTORY	FIXED
W26	6'-0" x 6'-0"	ALUMINUM CASING	ANODIZED	CLERESTORY	FIXED
W27	6'-0" x 6'-0"	ALUMINUM CASING	ANODIZED	CLERESTORY	FIXED
W28	6'-0" x 6'-0"	ALUMINUM CASING	ANODIZED	CLERESTORY	FIXED
W29	6'-0" x 6'-0"	ALUMINUM CASING	ANODIZED	CLERESTORY	FIXED
W30	6'-0" x 6'-0"	ALUMINUM CASING	ANODIZED	CLERESTORY	FIXED
W31	6'-0" x 6'-0"	ALUMINUM CASING	ANODIZED	CLERESTORY	FIXED
W32	6'-0" x 6'-0"	ALUMINUM CASING	ANODIZED	CLERESTORY	FIXED
W33	6'-0" x 6'-0"	ALUMINUM CASING	ANODIZED	CLERESTORY	FIXED
W34	6'-0" x 6'-0"	ALUMINUM CASING	ANODIZED	CLERESTORY	FIXED
W35	6'-0" x 6'-0"	ALUMINUM CASING	ANODIZED	CLERESTORY	FIXED
W36	6'-0" x 6'-0"	ALUMINUM CASING	ANODIZED	CLERESTORY	FIXED
W37	6'-0" x 6'-0"	ALUMINUM CASING	ANODIZED	CLERESTORY	FIXED
W38	6'-0" x 6'-0"	ALUMINUM CASING	ANODIZED	CLERESTORY	FIXED
W39	6'-0" x 6'-0"	ALUMINUM CASING	ANODIZED	CLERESTORY	FIXED
W40	6'-0" x 6'-0"	ALUMINUM CASING	ANODIZED	CLERESTORY	FIXED
W41	6'-0" x 6'-0"	ALUMINUM CASING	ANODIZED	CLERESTORY	FIXED
W42	6'-0" x 6'-0"	ALUMINUM CASING	ANODIZED	CLERESTORY	FIXED
W43	6'-0" x 6'-0"	ALUMINUM CASING	ANODIZED	CLERESTORY	FIXED
W44	6'-0" x 6'-0"	ALUMINUM CASING	ANODIZED	CLERESTORY	FIXED
W45	6'-0" x 6'-0"	ALUMINUM CASING	ANODIZED	CLERESTORY	FIXED
W46	6'-0" x 6'-0"	ALUMINUM CASING	ANODIZED	CLERESTORY	FIXED
W47	6'-0" x 6'-0"	ALUMINUM CASING	ANODIZED	CLERESTORY	FIXED
W48	6'-0" x 6'-0"	ALUMINUM CASING	ANODIZED	CLERESTORY	FIXED
W49	6'-0" x 6'-0"	ALUMINUM CASING	ANODIZED	CLERESTORY	FIXED
W50	6'-0" x 6'-0"	ALUMINUM CASING	ANODIZED	CLERESTORY	FIXED
W51	6'-0" x 6'-0"	ALUMINUM CASING	ANODIZED	CLERESTORY	FIXED
W52	6'-0" x 6'-0"	ALUMINUM CASING	ANODIZED	CLERESTORY	FIXED
W53	6'-0" x 6'-0"	ALUMINUM CASING	ANODIZED	CLERESTORY	FIXED
W54	6'-0" x 6'-0"	ALUMINUM CASING	ANODIZED	CLERESTORY	FIXED
W55	6'-0" x 6'-0"	ALUMINUM CASING	ANODIZED	CLERESTORY	FIXED
W56	6'-0" x 6'-0"	ALUMINUM CASING	ANODIZED	CLERESTORY	FIXED
W57	6'-0" x 6'-0"	ALUMINUM CASING	ANODIZED	CLERESTORY	FIXED
W58	6'-0" x 6'-0"	ALUMINUM CASING	ANODIZED	CLERESTORY	FIXED
W59	6'-0" x 6'-0"	ALUMINUM CASING	ANODIZED	CLERESTORY	FIXED
W60	6'-0" x 6'-0"	ALUMINUM CASING	ANODIZED	CLERESTORY	FIXED
W61	6'-0" x 6'-0"	ALUMINUM CASING	ANODIZED	CLERESTORY	FIXED
W62	6'-0" x 6'-0"	ALUMINUM CASING	ANODIZED	CLERESTORY	FIXED
W63	6'-0" x 6'-0"	ALUMINUM CASING	ANODIZED	CLERESTORY	FIXED
W64	6'-0" x 6'-0"	ALUMINUM CASING	ANODIZED	CLERESTORY	FIXED
W65	6'-0" x 6'-0"	ALUMINUM CASING	ANODIZED	CLERESTORY	FIXED
W66	6'-0" x 6'-0"	ALUMINUM CASING	ANODIZED	CLERESTORY	FIXED
W67	6'-0" x 6'-0"	ALUMINUM CASING	ANODIZED	CLERESTORY	FIXED
W68	6'-0" x 6'-0"	ALUMINUM CASING	ANODIZED	CLERESTORY	FIXED
W69	6'-0" x 6'-0"	ALUMINUM CASING	ANODIZED	CLERESTORY	FIXED
W70	6'-0" x 6'-0"	ALUMINUM CASING	ANODIZED	CLERESTORY	FIXED
W71	6'-0" x 6'-0"	ALUMINUM CASING	ANODIZED	CLERESTORY	FIXED
W72	6'-0" x 6'-0"	ALUMINUM CASING	ANODIZED	CLERESTORY	FIXED
W73	6'-0" x 6'-0"	ALUMINUM CASING	ANODIZED	CLERESTORY	FIXED
W74	6'-0" x 6'-0"	ALUMINUM CASING	ANODIZED	CLERESTORY	FIXED
W75	6'-0" x 6'-0"	ALUMINUM CASING	ANODIZED	CLERESTORY	FIXED
W76	6'-0" x 6'-0"	ALUMINUM CASING	ANODIZED	CLERESTORY	FIXED
W77	6'-0" x 6'-0"	ALUMINUM CASING	ANODIZED	CLERESTORY	FIXED
W78	6'-0" x 6'-0"	ALUMINUM CASING	ANODIZED	CLERESTORY	FIXED
W79	6'-0" x 6'-0"	ALUMINUM CASING	ANODIZED	CLERESTORY	FIXED
W80	6'-0" x 6'-0"	ALUMINUM CASING	ANODIZED	CLERESTORY	FIXED
W81	6'-0" x 6'-0"	ALUMINUM CASING	ANODIZED	CLERESTORY	FIXED
W82	6'-0" x 6'-0"	ALUMINUM CASING	ANODIZED	CLERESTORY	FIXED
W83	6'-0" x 6'-0"	ALUMINUM CASING	ANODIZED	CLERESTORY	FIXED
W84	6'-0" x 6'-0"	ALUMINUM CASING	ANODIZED	CLERESTORY	FIXED
W85	6'-0" x 6'-0"	ALUMINUM CASING	ANODIZED	CLERESTORY	FIXED
W86	6'-0" x 6'-0"	ALUMINUM CASING	ANODIZED	CLERESTORY	FIXED
W87	6'-0" x 6'-0"	ALUMINUM CASING	ANODIZED	CLERESTORY	FIXED
W88	6'-0" x 6'-0"	ALUMINUM CASING	ANODIZED	CLERESTORY	FIXED
W89	6'-0" x 6'-0"	ALUMINUM CASING	ANODIZED	CLERESTORY	FIXED
W90	6'-0" x 6'-0"	ALUMINUM CASING	ANODIZED	CLERESTORY	FIXED
W91	6'-0" x 6'-0"	ALUMINUM CASING	ANODIZED	CLERESTORY	FIXED
W92	6'-0" x 6'-0"	ALUMINUM CASING	ANODIZED	CLERESTORY	FIXED
W93	6'-0" x 6'-0"	ALUMINUM CASING	ANODIZED	CLERESTORY	FIXED
W94	6'-0" x 6'-0"	ALUMINUM CASING	ANODIZED	CLERESTORY	FIXED
W95	6'-0" x 6'-0"	ALUMINUM CASING	ANODIZED	CLERESTORY	FIXED
W96	6'-0" x 6'-0"	ALUMINUM CASING	ANODIZED	CLERESTORY	FIXED
W97	6'-0" x 6'-0"	ALUMINUM CASING	ANODIZED	CLERESTORY	FIXED
W98	6'-0" x 6'-0"	ALUMINUM CASING	ANODIZED	CLERESTORY	FIXED
W99	6'-0" x 6'-0"	ALUMINUM CASING	ANODIZED	CLERESTORY	FIXED
W100	6'-0" x 6'-0"	ALUMINUM CASING	ANODIZED	CLERESTORY	FIXED

COPYRIGHT © 2015, ROTUNDA HOMES, INC. ALL RIGHTS RESERVED.
 ROTUNDA HOMES, INC. RESERVES THE RIGHT TO VARY FROM PLANS, ADJUST SCHEDULES, MATERIALS, FINISHES, AND CONDITIONS OF CONTRACT.
 ROTUNDA HOMES, INC. NO UNAUTHORIZED USE OR REPRODUCTION IS ALLOWED WITHOUT WRITTEN PERMISSION FROM A CORPORATE OFFICER OF ROTUNDA HOMES, INC.
 SOME ITEMS DEPICTED HEREIN MAY BE OPTIONAL.
 ROTUNDA HOMES, INC. RESERVES THE RIGHT TO VARY FROM PLANS, ADJUST SCHEDULES, MATERIALS, FINISHES, AND CONDITIONS OF CONTRACT.
 ROTUNDA HOMES, INC. NO UNAUTHORIZED USE OR REPRODUCTION IS ALLOWED WITHOUT WRITTEN PERMISSION FROM A CORPORATE OFFICER OF ROTUNDA HOMES, INC.

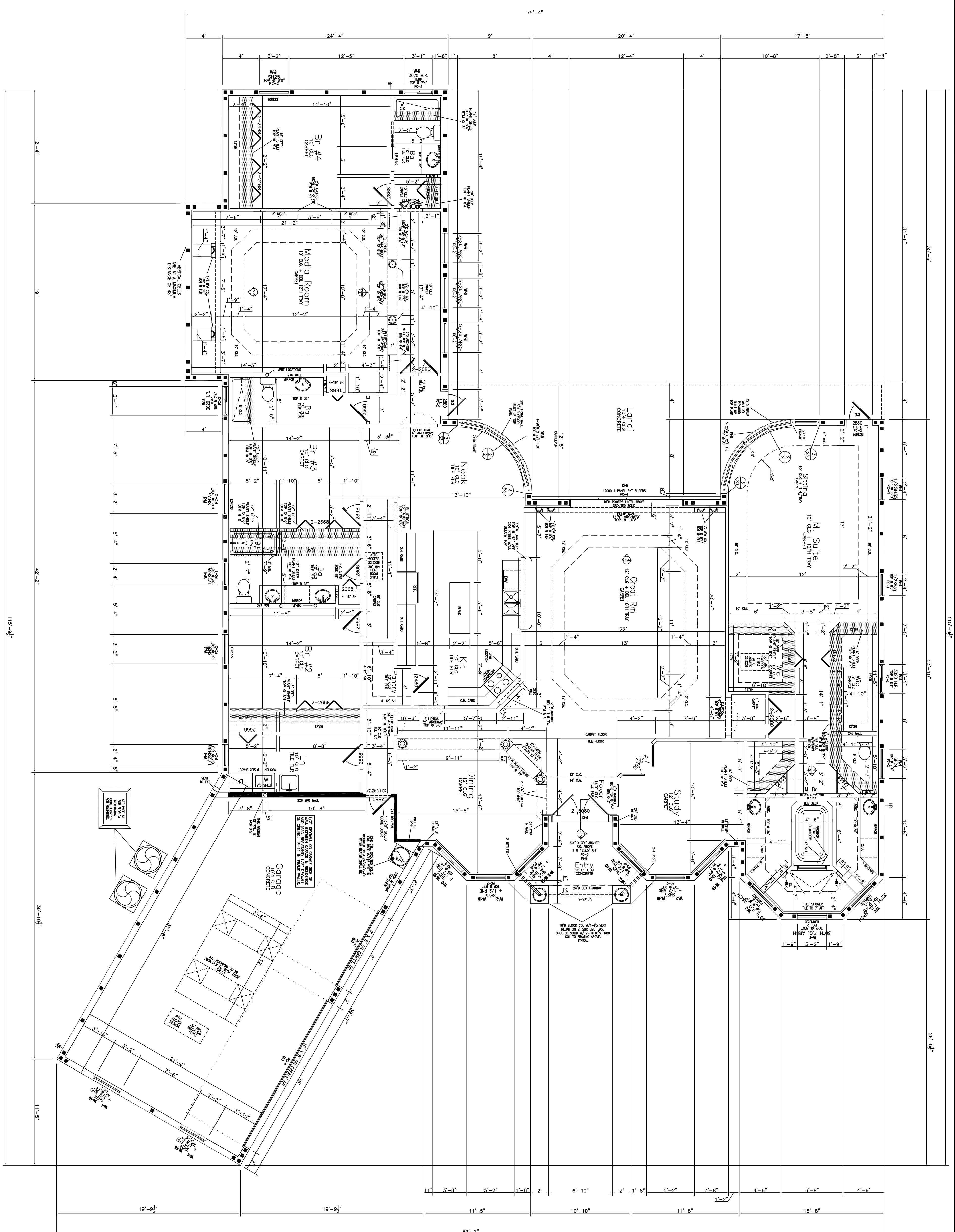

FLOOR PLAN
 SCALE: 3/16" = 1'

MODEL: GRAND CARAVELLE	DATE: 5/01/06	REVISION: STANDARD PLAN	DESIGNER: SW
C.A.D.#: TBD			
SHEET			
OF 6			

GRAND CARAVELLE (A)
LOT: TBD DEV: TBD COUNTY: TBD
STREET: TBD PLAN STATUS: TBD

BY INITIATING THE ATTACHED PLANS THE CLIENT SIGNIFIES HIS/HER APPROVAL OF THE PLANS WITH ANY REDLINE CHANGES NOTED.

CLIENT: _____ DATE: _____

CLIENT: _____ DATE: _____

INTEGRAL ENGINEERING INC.
 P.O. BOX 1698
 LUTZ, FL 33548
 PHONE: (813) 943-1100
 E.B. 8253

LUIS C. CORREA, FL P.E.
 #49018

* I HEREBY CERTIFY THAT I HAVE REVIEWED THIS DESIGN AND FOUND IT TO BE IN COMPLIANCE WITH 2004 FLORIDA BUILDING CODE, RESIDENTIAL.

* THIS DRAWING IS VALID FOR 12 MONTHS AFTER THE DATE IT IS SIGNED AND SEALED.

* SIGNED AND SEALED FOR THE STRUCTURAL PORTION OF THIS DRAWING ONLY.

WINDSPEED: T.B.D
 EXPOSURE: T.B.D
 ENG. CODE: T.B.D

WINDSPEED: T.B.D
EXPOSURE: T.B.D
ENG. CODE: T.B.D